

## Self-Contained Sliding Door Back Bar Refrigeration

Refrigeration



SD60L

### Standard Features

- 36"H, 1" stainless steel top
- 25" front to back depth
- Heavy duty sliding doors with built-in locks
- Built-in Cool White LED Lighting (7000K)
- All stainless steel, coved corner interior
- Digital thermostat
- DynamicChill 360° Technology
- NSF epoxy coated durable shelves, 1 bottom & 2 adjustable shelves per door
- Pre-drilled bottom for optional legs or casters (uses 1/4-20 self tapping 1/2"L screw)
- R290 Natural Refrigerant
- Eco-friendly refrigerant and insulation
- 5-Year compressor warranty
- 1-Year parts & labor warranty

### Models

Model	Length	Height	Depth	Compressor Side	Doors	Weight	Amps	HP
SD60L	60"	36"	25"	Left	2	360 lbs.	2.2	1/4
SD60R	60"	36"	25"	Right	2	360 lbs.	2.2	1/4
SD108L	108"	36"	25"	Left	4	720 lbs.	2.8	1/3
SD108R	108"	36"	25"	Right	4	720 lbs.	2.8	1/3

### Specifications

Electrical	<ul style="list-style-type: none"> <li>▪ 115 V, 1 Phase, 60 Hz</li> <li>▪ Furnished with 8'-0" plug-in cord, which exits left or right rear of cooler</li> <li>▪ NEMA 5-15P plug configuration</li> <li>▪ Dedicated 15 amp circuit recommended</li> <li>▪ 2 Door Units (60"): 2.2 amps, 1/4 HP</li> <li>▪ 4 Door Units (108"): 2.8 amps, 1/3 HP</li> </ul>
Refrigeration	<ul style="list-style-type: none"> <li>▪ R290 Hydrocarbon Refrigerant</li> <li>▪ 30°F - 40°F operating range</li> <li>▪ Digital thermostat on front grille</li> </ul>
Plumbing	<ul style="list-style-type: none"> <li>▪ No drain required</li> <li>▪ Condensate evaporator pan included</li> </ul>

Insulation	<ul style="list-style-type: none"> <li>▪ 2" thick foamed-in-place polyurethane</li> </ul>
Interior	<ul style="list-style-type: none"> <li>▪ 20 gauge stainless steel walls with coved corners</li> <li>▪ NSF epoxy coated durable shelves - one bottom and two adjustable shelves per door</li> </ul>
Exterior	<ul style="list-style-type: none"> <li>▪ Sides: 20 gauge stainless steel</li> <li>▪ Front: Glass with black vinyl doors</li> <li>▪ Back: 20 gauge galvanized steel</li> <li>▪ Top: 1" stainless steel top</li> </ul>
Doors	<ul style="list-style-type: none"> <li>▪ Heavy duty, glass with black vinyl sliding doors</li> <li>▪ 19-3/4"W x 29-11/16"H door opening</li> </ul>

### Case Capacity

Model	SD60 (60")	SD108 (108")
Long Neck Bottles	15.5	30
12 oz Cans	20	40
Wine Bottles (ea)	162	288



This equipment is intended for the storage and display of non-potentially hazardous bottle or canned products only.

This equipment is intended for use in an area where the ambient temperature typically does not exceed 75 °F.

## Self-Contained Sliding Door Back Bar Refrigeration

Refrigeration

### Two Door (60")

Models beginning SD60

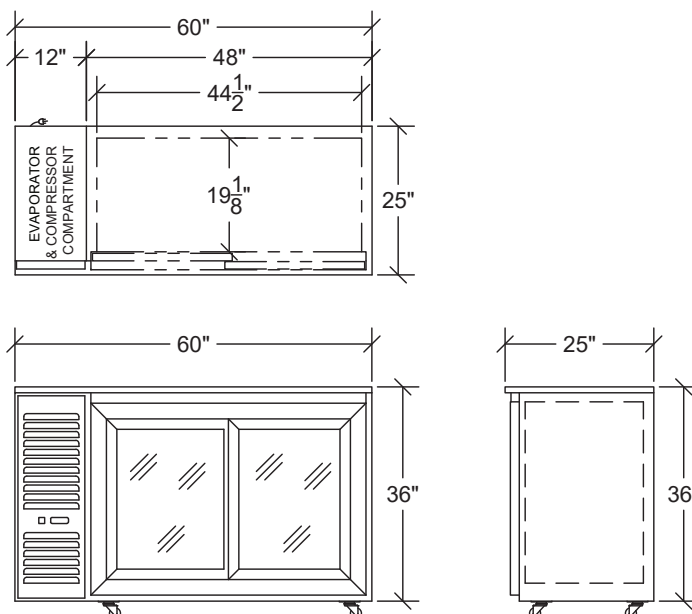

### Four Door (108")

Models beginning SD108

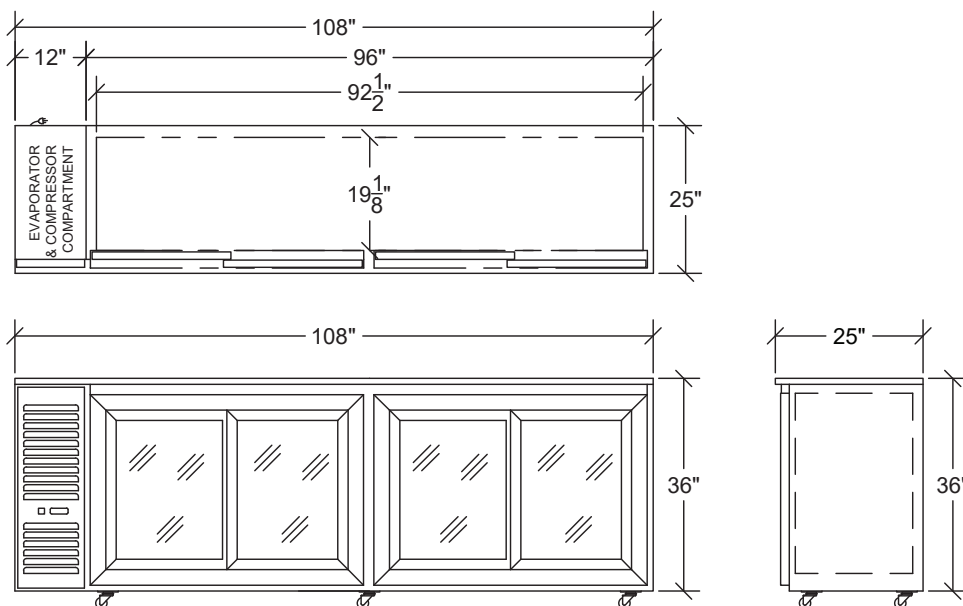

**Note:** Optional casters raise height 1" higher than wheel size

**Note:** Optional 4" or 6" legs available

This equipment is intended for the storage and display of non-potentially hazardous bottle or canned products only.

This equipment is intended for use in an area where the ambient temperature typically does not exceed 75 °F.