

8" Center Deck Mount Faucets

ROYAL SERIES



13-806L

| Model | Spout Type | Spout Length (A) | Spout Height (B) | Base to Top (C) | Weight |
|---------|------------|------------------|------------------|-----------------|----------|
| 13-806L | Standard | 6" | 2-1/4" | 4-5/8" | 2.5 lbs. |
| 13-808L | Standard | 8" | 2-5/8" | 5" | 3 lbs. |
| 13-810L | Standard | 10" | 3" | 5-3/8" | 2.5 lbs. |
| 13-812L | Standard | 12" | 3-3/8" | 5-3/4" | 3.5 lbs. |
| 13-814L | Standard | 14" | 3-5/8" | 6" | 3 lbs. |
| 13-816L | Standard | 16" | 4-1/8" | 6-3/8" | 3 lbs. |
| 13-8XXL | Base Only | - | - | - | 2 lbs. |

Standard Features

- 1/4 turn ceramic valves
- Durable full range swing spout with double o-ring construction
- Lever handles with vandal resistant wrist blade, handle upgrade option

Specifications

| | |
|-------------|-------------------------------|
| Water Inlet | 1/2" NPS Male |
| Temp. Range | 40°F - 180°F |
| Rough In | 7/8" Round Holes on 4" Center |
| Flow Rate | 1.8 GPM |
| Material | Chrome Plated Brass |

Product Compliance

- NSF-61 & NSF/ANSI 372
- NSF/ANSI/CAN 61: Q < 1
- ASME A112.18.1-2012/CSA B125.1-12
- Massachusetts Listed
- CEC Listed
- Meets ANSI A117.1 (ADA)

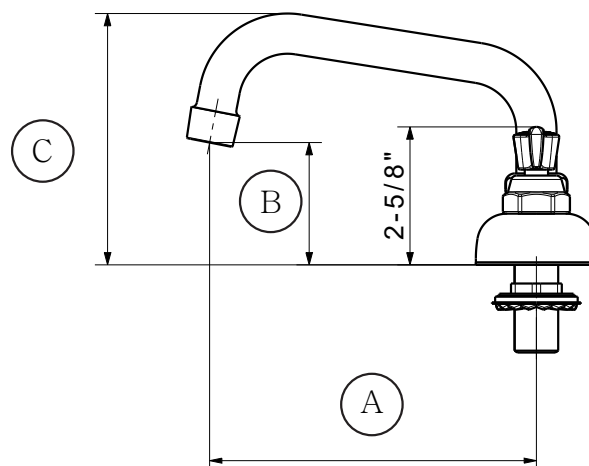
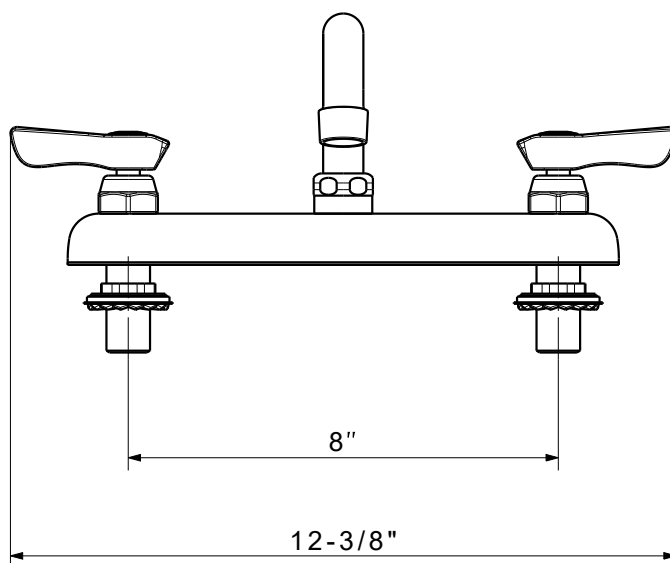

Warning:

Plumbing connections should be made by qualified personnel who will observe all applicable plumbing, sanitary and safety codes

California Prop 65 Warning:

This product can expose you to chemicals including lead and lead compounds, which are known to the State of California to cause cancer and birth defects or other reproductive harm. For more information go to www.P65Warnings.ca.gov.

8" Center Deck Mount Faucets

ROYAL SERIES



13-818L



13-801L

| Model | Spout Type | Spout Length (A) | Spout Height (B) | Base to Top (C) | Weight |
|---------|------------|------------------|------------------|-----------------|---------|
| 13-801L | Gooseneck | 6-1/4" | 5-5/8" | 9-1/2" | 2.5 lbs |
| 13-802L | Gooseneck | 8-1/8" | 7-7/8" | 12-5/8" | 3 lbs |
| 13-818L | Jointed | 18" | 4-3/4" | 7-7/8" | 3.5 lbs |
| 13-824L | Jointed | 24" | 7" | 10" | 4 lbs |

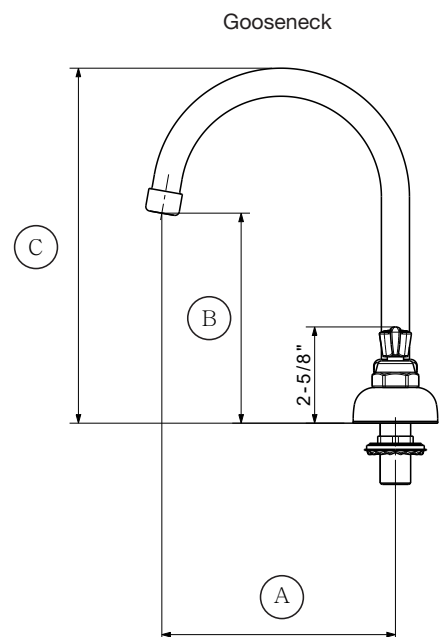
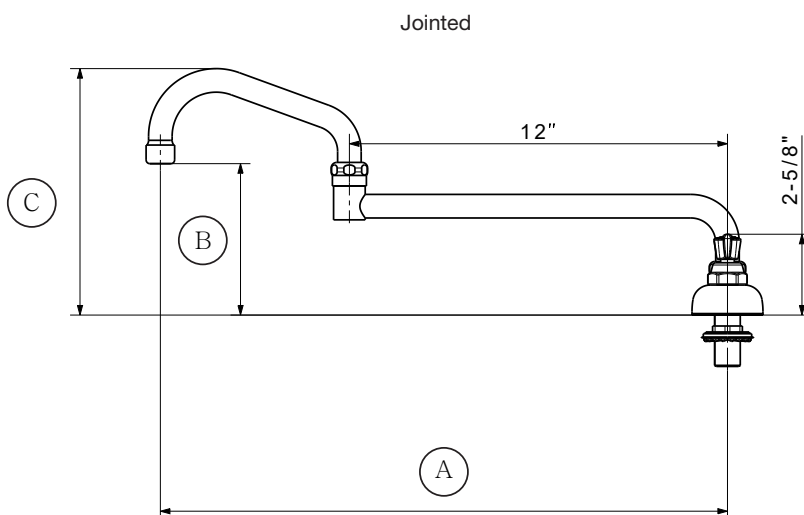

Warning:

Plumbing connections should be made by qualified personnel who will observe all applicable plumbing, sanitary and safety codes

California Prop 65 Warning:

This product can expose you to chemicals including lead and lead compounds, which are known to the State of California to cause cancer and birth defects or other reproductive harm. For more information go to www.P65Warnings.ca.gov.