

## Single Hole Deck Mount Pot Filler Faucet

## ROYAL SERIES



16-160L



16-162L



16-161L



16-163L

### Standard Features

- Single hole, single temp
- 1/4 turn high-performance ceramic cartridge valve with integral check
- Full flow with cross handle shut-off at end of spout
- Durable full range swing spout with double o-ring construction
- Mounting kit included

### Specifications

Water Inlet	1/2" NPS Male
Temp. Range	40°F - 180°F
Rough In	7/8"
Flow Rate	4.15 GPM
Material	Chrome Plated Brass

Model	Spout Length (A)	Joint Length (B)	Spout Height (C)	Overall Height (D)	Spout Type	Weight
16-160L	6"	-	4-1/4"	7-3/4"	Swing	2 lbs.
16-161L	6"	6"	7"	10-1/2"	Jointed	3 lbs.
16-162L	6"	12"	7"	10-1/2"	Jointed	3 lbs.
16-163L	12"	24"	7-3/8"	11"	Jointed	3.25 lbs.

### Product Compliance

- NSF-61 & NSF/ANSI 372
- NSF/ANSI/CAN 61: Q < 1
- ASME A112.18.1-2012/CSA B125.1-12
- Massachusetts Approved



16-160L

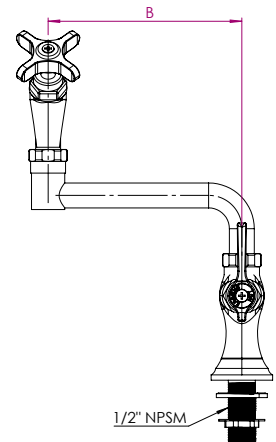
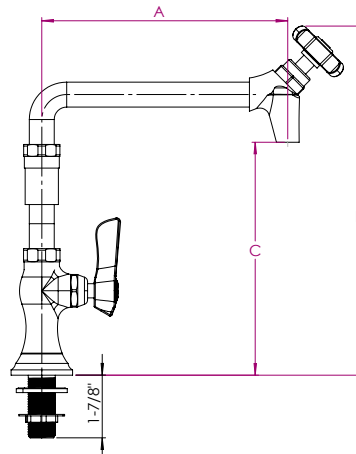
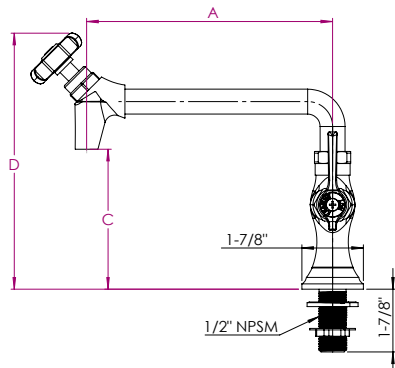

#### Warning:

Plumbing connections should be made by qualified personnel who will observe all applicable plumbing, sanitary and safety codes

#### California Prop 65 Warning:

This product can expose you to chemicals including lead and lead compounds, which are known to the State of California to cause cancer and birth defects or other reproductive harm. For more information go to [www.P65Warnings.ca.gov](http://www.P65Warnings.ca.gov).