

Single Lever Deck Mount Remote Valve with Remote Spout ROYAL SERIES



Model	Description
16-330L	Single Lever Deck Mount Remote Valve with 3-1/2" Remote Gooseneck Spout
16-331L	Single Lever Deck Mount Remote Valve with 6" Remote Swing Spout
16-332L	Single Lever Deck Mount Remote Valve with 8" Remote Swing Spout
16-333L	Single Lever Deck Mount Remote Valve with 10" Remote Swing Spout
16-33XL	Royal Series Single Lever Deck Mount Remote Valve (No Spout)

Product Compliance

- NSF/ANSI/CAN 61: Q < 1
- NSF/ANSI/CAN 372-2022
- ASME A112.18.1-2018/CSA B125.1-18
- Meets ANSI A117.1 (ADA)



Standard Features

- Durable full range remote spout with double o-ring construction
- Ceramic cartridge valve with built-in temperature limit stop
- Pre-installed water lines with 3/8" compression female inlets
- Single lever handle with color coded index

Specifications

Control Base Water Inlet	3/8" Compression Inlets
Control Base Water Outlet	1/2" NPS Female
Remote Spout Water Inlet	1/2" NPS Male
Control Base Rough In	1-1/2" Round Hole
Remote Spout Rough In	7/8" Round Hole
Temperature Range	40°F - 180°F
Pressure	20 - 120 PSI
Flow Rate	1.8 GPM
Material	Solid Brass
Finish	Chrome Plated Finish

Model	Spout Type	Spout Height (A)	Spout Length (B)	Weight
16-330L	Gooseneck	5-5/8"	3-1/2"	5 lbs.
16-331L	Standard	2"	8"	5 lbs.
16-332L	Standard	2-7/16"	8"	5.25 lbs.
16-333L	Standard	2"	10"	5.5 lbs.
16-33XL	-	-	-	4 lbs.

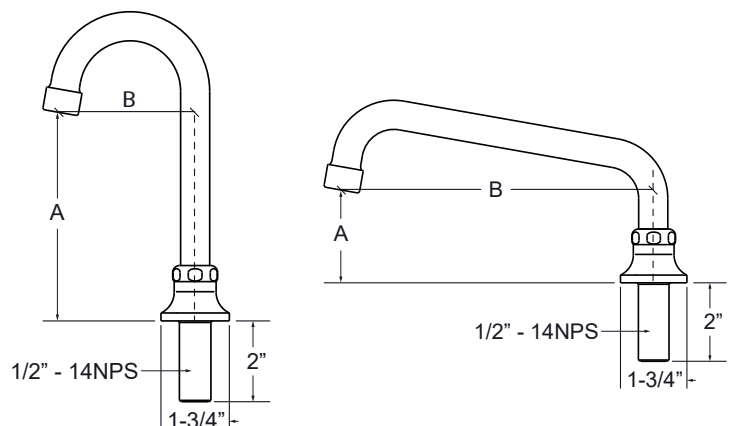
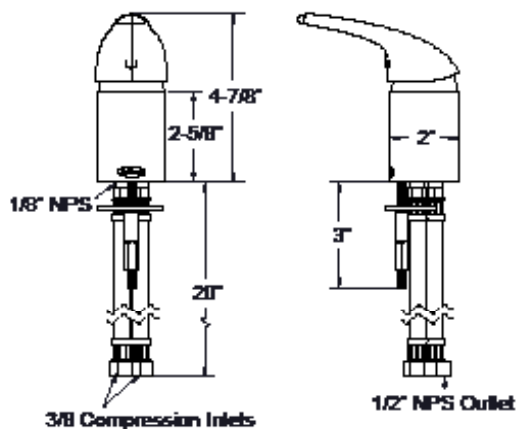

Warning:

Plumbing connections should be made by qualified personnel who will observe all applicable plumbing, sanitary and safety codes

California Prop 65 Warning:

This product can expose you to chemicals including lead and lead compounds, which are known to the State of California to cause cancer and birth defects or other reproductive harm. For more information go to www.cdph.ca