

Kitchen and Pantry Faucet with Sprayer

ROYAL SERIES



Standard Features

- Ceramic cartridge valve with metal stem
- Single lever 6" or 8" center deck mount kitchen faucet with 9-3/16" spout
- Spray attachment with 1" diameter mount
- Pre-installed 3/8" compression water lines on faucet
- 70" hose on sprayer
- Single lever handle
- Warranty: 1 year

Model	Description	Weight
16-350L	Kitchen Faucet with Sprayer	5 lbs.
16-351L	Kitchen Faucet Only (No Sprayer)	3 lbs.
16-352L	Sprayer Only	2 lbs.

Note: Sprayer cannot be added on in the field

Specifications

Water Inlet	3/8" Compression
Centers	Single Hole
Rough In	3/8" Threaded Rods on 6" or 8" Center
Temp. Range	40° - 140°F
Pressure	20 - 125 PSI
Flow Rate	1.8 GPM
Material	Solid Brass
Finish	Chrome Plated Finish

Product Compliance

Faucet

- NSF/ANSI/CAN 372-2022
- ASME A112.18.1-2024/CSA B125.1-24
- NSF/ANSI 61-2015
- NSF/ANSI 372-2024



Sprayer

- NSF/ANSI/CAN 372-2022

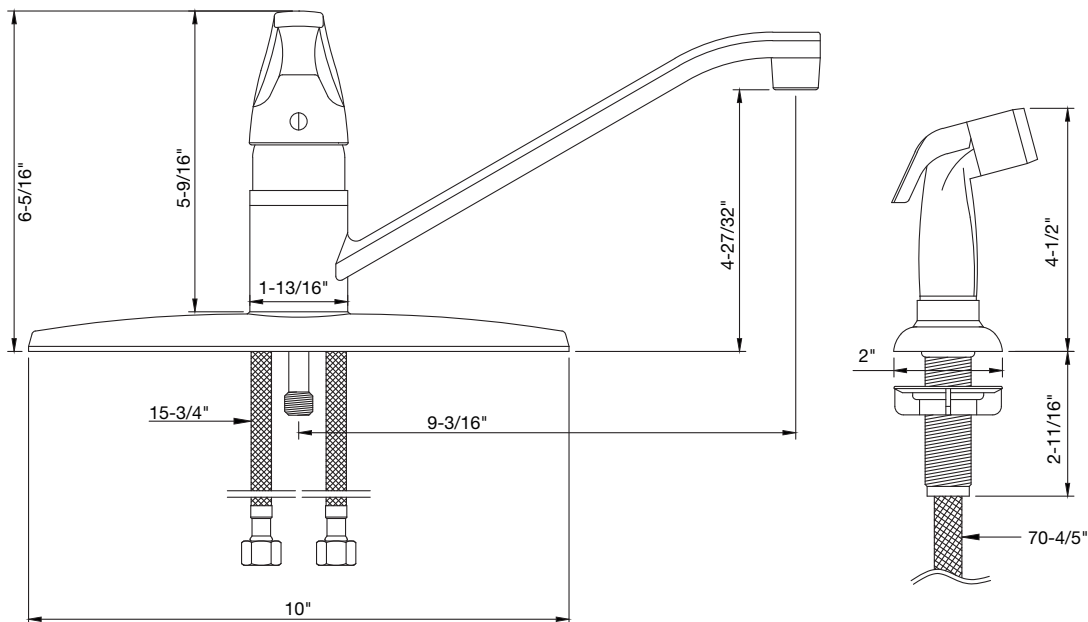

Warning:

Plumbing connections should be made by qualified personnel who will observe all applicable plumbing, sanitary and safety codes

California Prop 65 Warning:

This product can expose you to chemicals including lead and lead compounds, which are known to the State of California to cause cancer and birth defects or other reproductive harm. For more information go to www.cdph.ca.gov/Programs/CID/DCDC/Pages/Default.aspx