

## Wall Mount Utility Spray

## ROYAL SERIES



19-108L



19-101L

Model	Inlet	Centers	Weight
19-101L	1/2" NPS Male	Single Hole	12 lbs.
19-108L	1/2" NPS Male Kit Installed	8"	13 lbs.

### Product Compliance

- NSF-61 & NSF/ANSI 372
- NSF/ANSI/CAN 61: Q<1
- ASME A112.18.1-2012/CSA B125.1-12
- Massachusetts Listed



### Standard Features

- 1/4 turn high performance ceramic cartridge valves with integral check
- Pre-assembled vacuum breaker
- 72" stainless steel clad flexible hose, tested to 400 PSI
- Plastic-coated wall hook with chrome base and mounting screws
- Mounting kit (21-194L) includes (2) locknuts, (2) rosette washers, (2) rubber o-rings and (2) shanks
- Full replacement parts available
- 3 year warranty

### Specifications

Rough In	7/8" Round Holes
Temp. Range	40° - 180°F
Material	Chrome Plated Brass
Flow Rate	2.2 GPM @ 60 PSI

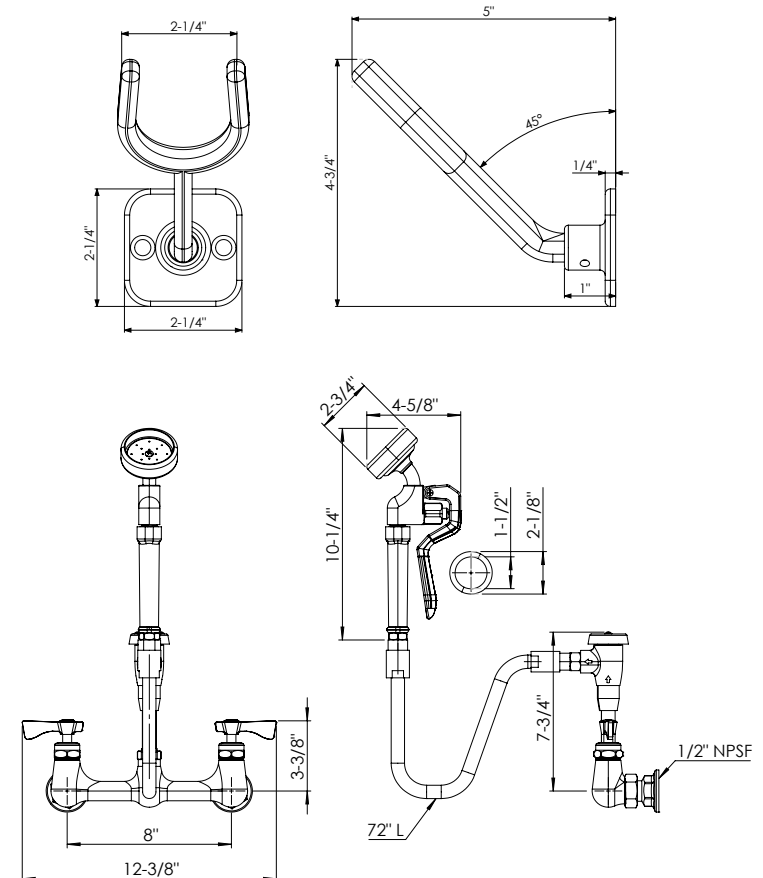
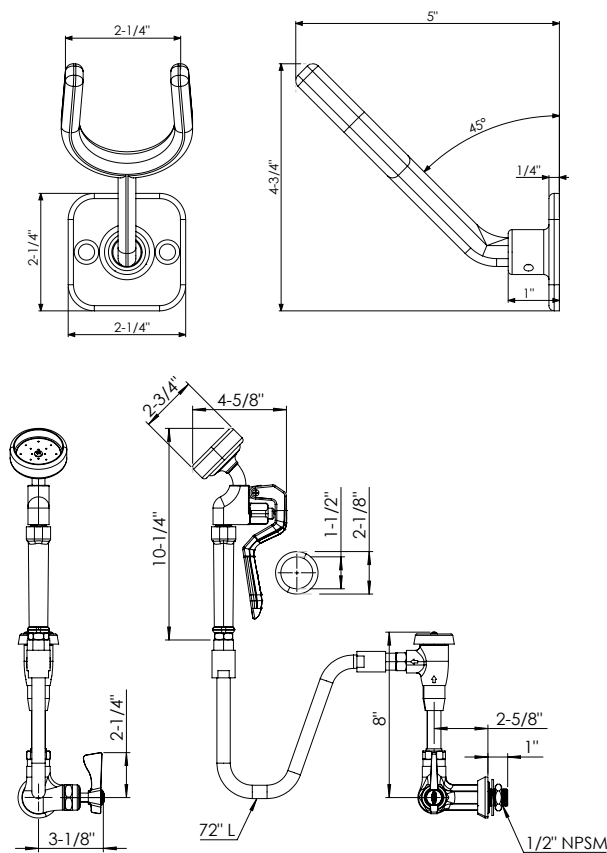

#### Warning:

Plumbing connections should be made by qualified personnel who will observe all applicable plumbing, sanitary and safety codes

#### California Prop 65 Warning:

This product can expose you to chemicals including lead and lead compounds, which are known to the State of California to cause cancer and birth defects or other reproductive harm. For more information go to [www.cdph.ca](http://www.cdph.ca)