

Glass Storage Cabinets

ROYAL SERIES



KR24-GSB1
Adjustable Slides (3 racks)



KR24-GSB3
Middle Shelf (2 racks)



KR24-GSB4
Middle Shelf/Cutting Board (2 racks)



KR24-GSB5
Roll Out Shelves (2 racks)



KR24-24SC
Storage with Hand Sink

Model	Description	20" x 20" Glass Rack Capacity	Weight
KR24-GSB1	Royal Series 24"L x 24"D Glass Storage Cabinet with Glass Rack Slides	3	40 lbs.
KR24-GSB3	Royal Series 24"L x 24"D Glass Storage Cabinet with Middle Shelf	2	48 lbs.
KR24-GSB4	Royal Series 24"L x 24"D Glass Storage Cabinet with Middle Shelf & Cutting Board	2	60 lbs.
KR24-GSB5	Royal Series 24"L x 24"D Glass Storage Cabinet with Roll Out Shelves	2	60 lbs.
KR24-24SC	Royal Series 24"L x 24"D Glass Storage Cabinet with Right Side Sink	-	70 lbs.
KR24-24SC-L	Royal Series 24"L x 24"D Glass Storage Cabinet with Left Side Sink	-	70 lbs.

Standard Features

- Open front base for glass storage
- Drainboard top, optional perforated insert available
- Glass racks not included
- Royal Series faucet included with hand sink models KR24-24SC and KR24-24SC-L

Optional Accessories

KR-313	Left and Right End Side Splashes
KR-314	Right End Side Splash
KR-315	Left End Side Splash
30-160	Glass Storage with Left Side Sink (For KR24-24SC and KR24-24SC-L)
30-152	Glass Storage with Right Side Sink (For KR24-24SC and KR24-24SC-L)
21-443L	E-Z Install Flexible Water Line Kit (For KR24-24SC and KR24-24SC-L)
KR24-PE24	24" Perforated Insert (For KR24-GSB1 and KR24-GSB3 and KR24-GSB5)

Specifications

Drainboard	20 gauge embossed stainless steel reinforced with welded braces every 6" 3/4" radius on all vertical and horizontal edges Perforated insert is optional except for model KR24-GSB4 where it is included
Material	Front Apron, Sides, Backsplash, & Shelf: 20 gauge stainless steel Back and bottom: 20 gauge stainless steel
Legs	1-5/8" tubular 16 gauge stainless steel with grey plastic bullet foot
Plumbing	1/2" drain on right rear of drainboard (23-110) (KR24-24SC and KR24-24SC-L does not have this drain as liquid drains directly to sink bowl) 1" bottom shelf drain (23-111) 1-1/2" drain on KR24-24SC sink bowl (23-122)
Cutting Board	Non-slip flush mounted cutting board on model KR24-GSB4 (CB-127)



Glass Storage Cabinets

ROYAL SERIES



KR24-GSB1

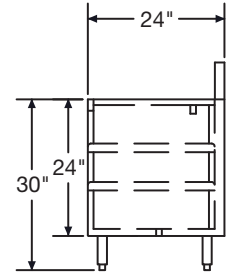
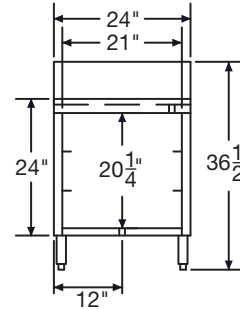
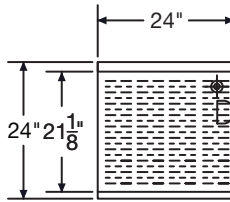

KR24-GSB3

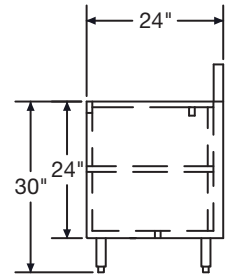
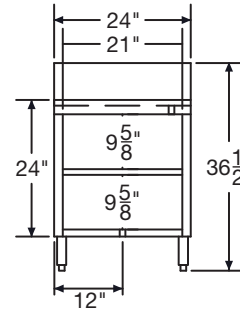
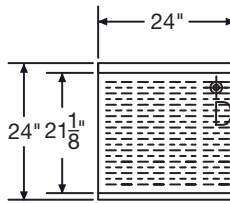

KR24-GSB4

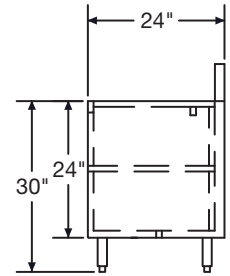
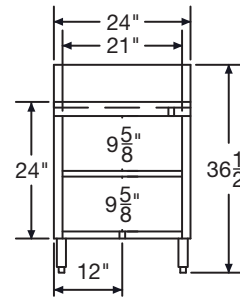
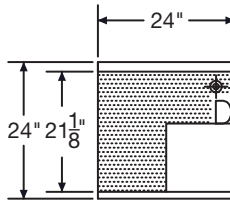

KR24-GSB5

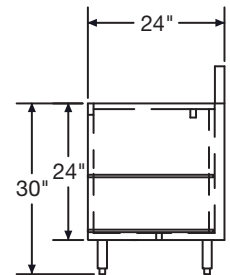
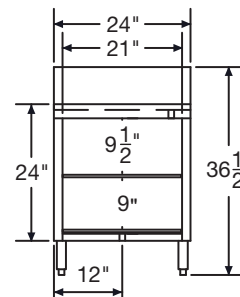
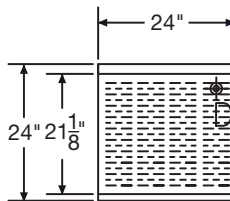

**KR24-24SC
KR24-24SC-L**

KR24-24SC shown

KR24-24SC-L
is exact opposite
with sink on left.

