

Combination Ice Bins with 12" Bottle Storage

ROYAL SERIES



KR19-M36L



KR24-M36R



KR24-M48C

Standard Features

- 12" deep ice bin with 1" drain, 1/2" drain with cold plate units
- Insulated 12" bin section for wire racks or bottle wells with 1" drain
- Soda line access cutout in rear on cold plate units
- Optional 15" deep liner that holds 25% more ice (KR-502)
- Optional built-in speed rail
- 10-Circuit cold plate available depending on model
- Ice bins with cold plates include 1/2" x 6" PVC tailpiece (1/2" - 20 male threaded)
- Ships as a complete station

Specifications

Material	Interior: 20 gauge stainless steel; 12" deep ice bin section, 10" deep bottle section Front Apron: 20 gauge stainless steel Backsplash: 20 gauge stainless steel; 6-1/2"H x 1-1/2"D Back and Bottom: 20 gauge stainless steel Sides: 20 gauge stainless steel
Legs	1-5/8" tubular 16 gauge stainless steel with grey plastic bullet foot
Insulation	Foamed-in-place polyurethane
Cold Plate	Cast aluminum post mix plate with 10 circuits Plate is sealed into bottom Each circuit is 5/16" OD stainless steel tubing Bump and swedge fittings on end of circuits
Plumbing	1/2" IPS hot and cold water 1-1/2" IPS drain connection PVC tailpiece required to avoid condensation through metal to metal contact (for ice bins with a cold plate)
Tubing Access	3/4" x 3-1/2" cutout in left side of backsplash
Legs	1-5/8" tubular legs with grey bullet feet

Optional Speed Rails



RS-24



RD-24

Single Speed Rails

Model	Length
RS-36	36"
RS-42	42"
RS-48	48"

Double Speed Rails

Model	Length
RD-36	36"
RD-42	42"
RD-48	48"



Combination Ice Bins with 12" Bottle Storage

ROYAL SERIES

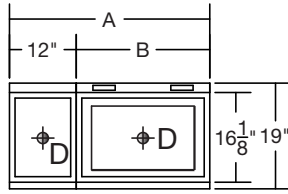
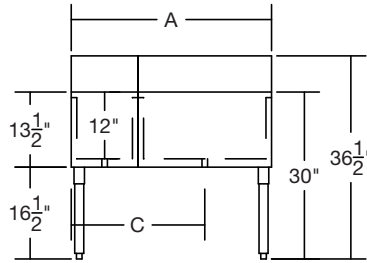
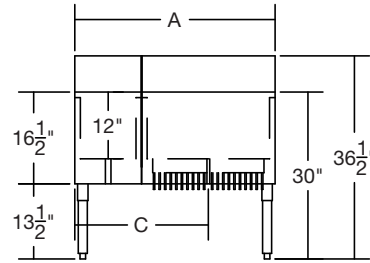
Top View

Front View

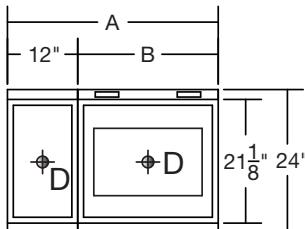
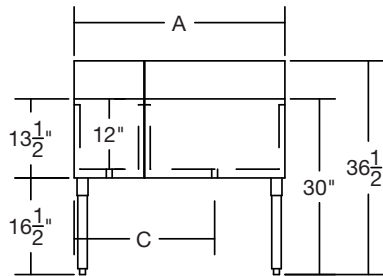
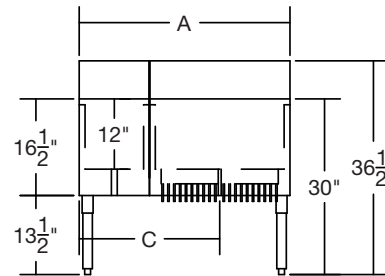
Front View - Cold plate models

Model	Weight	Model with Cold Plate	Weight	Overall Length (A)	Depth	Ice Bin Length (B)	Ice Bin Location	Left Side to Ice Bin Drain (C)	Ice Capacity (lbs.)	Bottles Stored
KR19-M30R	74 lbs.	KR19-M30R-10	150 lbs.	30"	19"	24"	Right	21"	75	3
KR19-M30L	74 lbs.	KR19-M30L-10	150 lbs.	30"	19"	24"	Left	12"	75	3
KR19-M36R	95 lbs.	KR19-M36R-10	170 lbs.	36"	19"	24"	Right	24"	75	6
KR19-M36L	95 lbs.	KR19-M36L-10	170 lbs.	36"	19"	24"	Left	12"	75	6
KR19-M42R	108 lbs.	KR19-M42R-10	185 lbs.	42"	19"	30"	Right	27"	90	6
KR19-M42L	108 lbs.	KR19-M42L-10	185 lbs.	42"	19"	30"	Left	15"	90	6
KR19-M48R	116 lbs.	KR19-M48R-10	195 lbs.	48"	19"	36"	Right	30"	110	6
KR19-M48L	116 lbs.	KR19-M48L-10	195 lbs.	48"	19"	36"	Left	18"	110	6
KR19-M48C	116 lbs.	KR19-M48C-10	195 lbs.	48"	19"	24"	Center	24"	75	12

Top View

Front View

Front View - Cold plate models

Model	Weight	Model with Cold Plate	Weight	Overall Length (A)	Depth	Ice Bin Length (B)	Ice Bin Location	Left Side to Ice Bin Drain (C)	Ice Capacity (lbs.)	Bottles Stored
KR24-M36R	108 lbs	KR24-M36R-10	185 lbs	36"	24"	24"	Right	21"	90	8
KR24-M36L	108 lbs	KR24-M36L-10	185 lbs	36"	24"	24"	Left	12"	90	8
KR24-M42R	121 lbs	KR24-M42R-10	198 lbs	42"	24"	30"	Right	27"	115	8
KR24-M42L	121 lbs	KR24-M42L-10	198 lbs	42"	24"	30"	Left	15"	115	8
KR24-M48R	129 lbs	KR24-M48R-10	206 lbs	48"	24"	36"	Right	30"	140	8
KR24-M48L	129 lbs	KR24-M48L-10	206 lbs	48"	24"	36"	Left	18"	140	8
KR24-M48C	129 lbs	KR24-M48C-10	206 lbs	48"	24"	24"	Center	24"	90	16

