



# HOSE REEL ASSEMBLY OPERATING INSTRUCTIONS

Read these instructions carefully before attempting to install, operate or maintain this product. Only qualified persons should install this product. Failure to comply with instructions may result in personal injury and/or property damage. Every attempt is made to ensure the accuracy and completion of these instructions; however, manufacturer is not responsible for omissions.

## SAFETY

1. Only use designated fluid media as specified by manufacturer. Contact manufacturer for information regarding other fluid media uses.
2. Before connecting reel to supply line, ensure that pressure and temperature does not exceed maximum working pressure rating of reel.
3. Remember, even low pressure is very dangerous and can cause personal injury or death.
4. Do not exceed maximum installation height of 16 feet unless specified.
5. A high tension spring assembly is contained within the reel. **Exercise extreme caution.** Do not open tamper-resistant compartment.
6. Remove all spring tension before beginning disassembly process.
7. Ensure that reel is properly installed before connecting input and output hoses.
8. **Bleed fluid/gas pressure from system before servicing reel.**
9. If a leak occurs in the hose or reel, remove system pressure immediately.
10. Pull hose from reel by grasping the hose itself, not the hose end attachment.
11. If reel ceases to unwind or rewind, remove system pressure immediately. Do not jerk excessively on hose!
12. Treat and respect the hose reel as any other piece of machinery, observing all common safety practices.

## INSTALLATION

A flexible hose connection must be used between the hose reel inlet and the source of supply to prevent possible misalignment and binding. The swivel union is packed separately in the reel carton, use Teflon tape or pipe sealant to assure a satisfactory seal when installing swivel. Do not over tighten.

## MOUNTING & GUIDE ARM ADJUSTMENT

The hose reel is equipped for universal mounting so that it can be mounted on a structurally sound floor, wall or ceiling; whichever provides maximum performance. The hose guide arm must

be rotated to a position that allows the hose to feed through the roller brackets with minimal bending. Replace the fasteners. When rotating guide arm, the U-bolt must be placed in the proper location, otherwise the reel might “latch or lock out” during use.

## LUBRICATION

Hose reel spring and bearings are factory-lubricated and require no further lubrication.

## INSTALL/REPLACE THE HOSE

**CAUTION:** Exercise extreme caution when adding or removing spring tension. **Ensure reel base is fastened down prior to adjusting tension.** Do not move spool while tightening hose or latch will disengage. Do not let go of the hose until latch mechanism is engaged.

1. To achieve proper tension, wind spool flange required number of turns. Do not over-tighten.
2. **Engage hose latching mechanism.**
3. Insert hose through roller guide.
4. Connect hose fitting to female outlet. Install hose bumper stop at desired position.

## SPRING TENSION ADJUSTMENTS

To adjust spring tension, add or remove wraps of hose from the spool, one wrap at a time, until desired tension is obtained (**refer to cautionary statements above**). Hose latching mechanism can be removed for constant tension applications.

## REPAIRS

To avoid damage and/or injury, extensive repairs should only be performed by the manufacturer’s service center.

Noncompliance may void warranty.

**CAUTION:** Remove all spring tension and system pressure before disassembly process.

**\*Note:** See Plumbing Installation Instructions for guidance on mounting faucet to wall or deck.

## SPRING DRIVEN HOSE REELS

<b>Complete Hose Reel Assemblies with Faucet*:</b>	
Enclosed, Gray Powder Coated	24-500, 24-501
Enclosed, Stainless Steel	24-502
Open, Stainless Steel	24-503
<b>Complete Hose Reel Assemblies:</b>	
Enclosed, Stainless Steel	24-600
Enclosed, Gray Powder Coated	24-601
Open, Stainless Steel	24-602
Open, Gray Powder Coated	24-603



## ONE YEAR LIMITED WARRANTY

Krowne offers a one year limited warranty on all hose reel assemblies. For complete warranty information, online warranty registration, service manuals and return information, please visit [www.krowne.com](http://www.krowne.com).

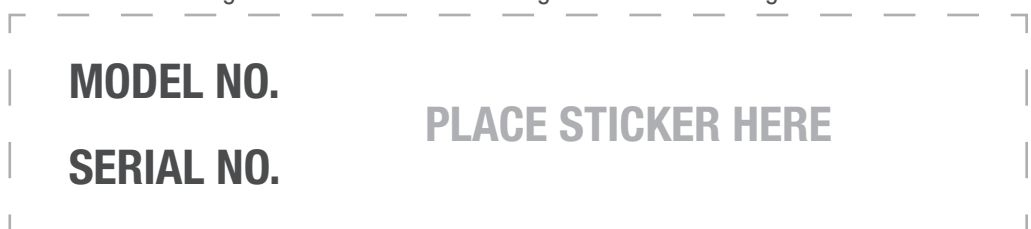



# HOSE REEL ASSEMBLY OPERATING INSTRUCTIONS

## DIMENSIONS & PRODUCT IMAGES

Note the size and distance between the mounting holes before installing.

### ENCLOSED HOSE REELS

- GRAY POWDER COATED ..... 24-500, 24-501, 24-601
- STAINLESS STEEL ..... 24-502, 24-600

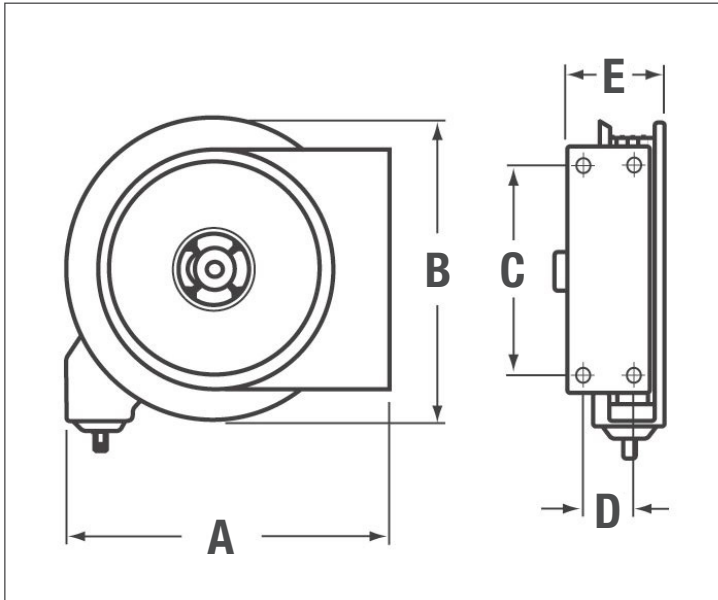

### MODELS

<b>A</b>	14 1/2"
<b>B</b>	15"
<b>C</b>	9 3/4"
<b>D</b>	2 1/2"
<b>E</b>	7"



### OPEN HOSE REELS

- GRAY POWDER COATED ..... 24-603
- STAINLESS STEEL ..... 24-503, 24-602

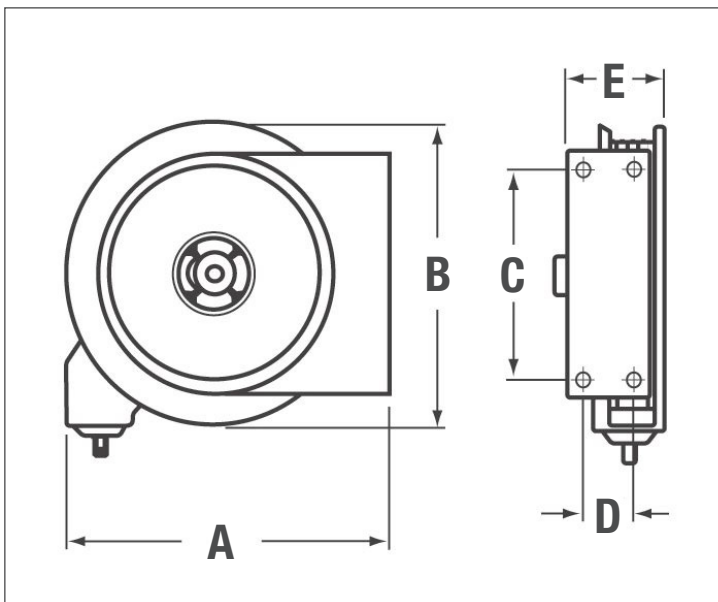

### MODELS

<b>A</b>	14 1/2"
<b>B</b>	13 3/4"
<b>C</b>	9 3/4"
<b>D</b>	2 1/2"
<b>E</b>	6"

