



Model: **HS-58** Item #: \_\_\_\_\_ Date: \_\_\_\_\_  
 Project: \_\_\_\_\_ Qty: \_\_\_\_\_ Approved By: \_\_\_\_\_

# 16" Wide Hand Sink with Soap & Towel Dispenser

Hand Sinks

## Product Description

- 16" Hand Sink, Includes Faucet, 1-1/2" Drain, Built-in Soap & Towel Dispenser, Includes Overflow & P-Trap, Two Side Supports and Wall Bracket



HS-58

## Specifications

- Size** 16"W x 15"D x 14"H
- Bowl** 12-1/2"W x 9-3/4"L x 5-5/8" Deep
- Fabrication** 20 gauge stainless steel
- Wall Mount Bracket** Offset design for added strength
- Faucet** 4" center wall mount faucet (10-435L), 0.5 GPM
- Drain** 1-1/2" Stainless steel drain
- Drain with Overflow** Stainless steel with plastic overflow tube and inlet (supplied with those sinks that contain an overflow hole)
- Weight** 35 lbs.
- Plumbing** 1/2" IPS hot and cold water. 1-1/2" IPS drain outlet. Install at 36" working height. 1/2" faucet supply 12" from floor. 1-1/2" drain line 23-1/4" from floor.
- Lead Free** Faucet included is certified to NSF/ANSI 61 and 372 and conforms with the lead content requirements for lead free plumbing as defined by the U.S. Safe Drinking Water Act. Hand sink is certified NSF-2.

## Replacement Parts & Accessories

Model	Description
21-311L	Wrist Blade Handle Kit
21-300L	Silver Series Faucet Valve Repair Kit
H-101	Deck Mount Soap Dispenser
H-105	Wall Mount Towel Dispenser
H-108-2	16"W x 15"D Stainless Steel Skirt, Factory Installed
H-110	Side Support Brackets
FG-L2	15"D Factory Installed Left Side Splash
FG-R2	15"D Factory Installed Right Side Splash
FG-LR2	15"D Factory Installed Left & Right Side Splashes
SG-L2	15"D Field Installed Left Side Splash
SG-R2	15"D Field Installed Right Side Splash
SG-LR2	15"D Field Installed Left & Right Side Splashes
10-435L	4" Center Faucet with 4-1/2" Double Bend Spout
21-300L	1/4 Turn Ceramic Valves
23-121	1-1/2" Drain (Locknut & Washer included)
21-443L	E-Z Install Flexible Water Line Kit
H-100	Chrome Plated 1-1/2" IPS P-Trap
H-110	Side Support Brackets
H-111	16"W Soap & Towel Dispenser
23-157	Overflow Assembly
H-116	Wall Mount Soap Dispenser

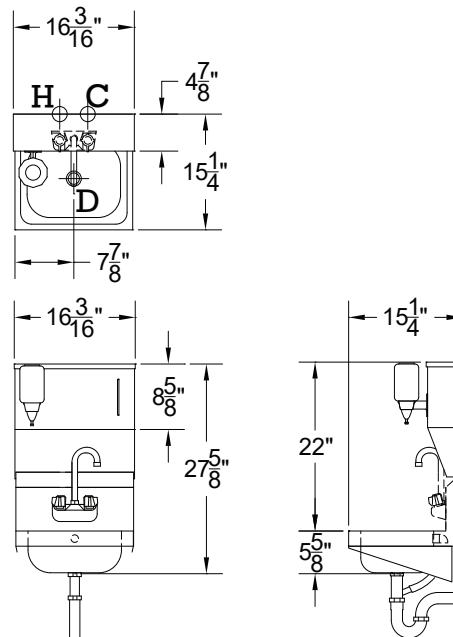

## Product Compliance

- NSF-2
- Massachusetts Approved



Warning: This product can expose you to chemicals including lead and lead compounds which are known to the State of California to cause cancer and birth defects or other reproductive harm. For more information go to [www.P65Warnings.ca.gov](http://www.P65Warnings.ca.gov).