

3 BEZEL SHAPES
"Kick-Proof" Stainless Steel with Titanium PVD Finish and Powder-Coat Options

ASYMMETRIC BEAM
Downward light, wide beam



Ember™

MARINE-GRADE LED MINIATURE STEP LIGHT

Ember is the world's premier marine LED courtesy light, offering beautiful illumination and more features and options than you'd ever expect from a light this small. Unique asymmetric beam angle to illuminate steps, hallways, and other low-level surfaces.

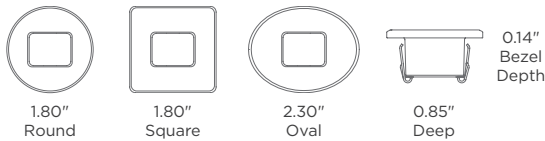

FEATURES

No Glare, Down-Angled Beam

Down-angled beam with washboard eliminates glare while wide beam profile provides even illumination across step and path surfaces.

Dimmable

Using our LightLink™ Dimmers, experience simple LED dimming at the push of a button.

Flexible Mounting

Snap or Screw into place. Your choice.

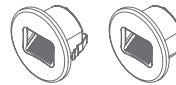

Rugged & Waterproof

With stainless steel construction and a PVD Titanium-Coated or Mil-Spec Powder-Coated stainless steel trim bezel, expect industry-leading fit and finish that will last. IP67 waterproof rated*.

Not Just for Yachts

Also runs on 12V AC landscape transformers and is cULus Listed, offering simple installation into decks, steps, and pathways.

*IP67 rated. Not for use in submersible applications.



Typical Applications

- Courtesy
- Cockpit
- Step Riser
- Pathway

Quick Specs

1.5 W	Power
Asym	Beam Angle
17	Lumen Output Typ.
Snap	Mounting
Screw	Mounting

LED Color

■	3000°K Warm White
■	6500°K Cool White
■	Green
■	Blue
■	Red

Finish Color

■	Polished Chrome (PVD TITANIUM)
■	Polished Gold (PVD TITANIUM)
■	Brushed Nickel (PVD TITANIUM)
■	White (MIL-SPEC POWDER COATED)
■	Off-White (MIL-SPEC POWDER COATED)

MODEL E1150/E2150 | MARINE-GRADE LED MINIATURE STEP LIGHT

The Ember is an IP67 marine-grade miniature LED step light available with either snap-in or screw-mount installation. The asymmetric beam angle and wide lateral throw provide even illumination across step and path surfaces. With the option for either titanium-coated PVD or mil-spec powder-coated trim, expect a premium finish that will withstand the elements of time. The trim is available in round, square or oval shape.



CUSTOMER COMPANY	CUSTOMER CONTACT
P.O.#	CUSTOMER PHONE #
SHIPPING ADDRESS	

FIXTURE BUILDER

OPTIONS

FIXTURE TYPE

- E1150Z** Snap Mount
- E2150Z** Screw Mount

FINISH

- PVD Titanium Coated**
- 1** Polished Chrome
 - 2** Polished Gold
 - 4** Brushed Nickel
- Powder Coated**
- 3** White
 - 5** Off-White

BEZEL SHAPE

- 1** Round
- 2** Square
- 3** Oval

LED COLOR

- AAH** Cool White 6500°K
- CAB** Warm White 3000°K
- D** Green
- E** Blue
- H** Red

RETAIL PACKAGING

Products available in retail packaging are listed below.

ACCESSORIES

DIMMING CONTROL

LIGHTLINK	
<input type="checkbox"/> LL-101	Momentary Switch Dimmer
<input type="checkbox"/> LL-105-R	0-10V Bridge & Dimmer

LightLink Dimmers dim up to 20 Embers using a single control wire for dimming.

See below for additional dimming information and wiring diagrams.

GASKET

PN	TYPE
<input type="checkbox"/> 530-00486	Closed Cell Foam

POWER BOXES

MODEL	VOLTAGE	POWERS
Dimmable AC Transformer Box		
<input type="checkbox"/> E03 (indoor)	120V AC	16 Embers
<input type="checkbox"/> E11 (indoor/outdoor)	120V AC	16 Embers
AC Power Box		
<input type="checkbox"/> E05PW (indoor/outdoor)	120-277V AC	20 Embers

For fixed "onshore" installations, use a Power Box to convert High Voltage to Low Voltage. Transformer Boxes as listed convert 120V AC to 12V AC and are dimmable using a Magnetic Low Voltage Dimmer on the AC Primary.

QUICK SPECS

Input Voltage	9-30V DC, 9-15V AC
Input Power	1.5 Watts Typ, 2.5 Watts Max
Lumens	17 lms typ @ 3000°K
Efficiency	11 lms / W typ. @ 3000°K
Beam Angle	Asymmetric
Operating Temp	-20°C to 40°C
Max. Case Temp	50°C
IP Rating	IP67
Wiring	6" Twisted 18 AWG
Housing	Stainless Steel Trim, Anodized Aluminum Housing
Lens	Polycarbonate

RETAIL PACKAGING

AVAILABLE IN RETAIL BLISTER PACK

PART NUMBER	LED COLOR	FINISH	SHAPE
E1150Z-11AAH	Cool White	Chrome	Round
E1150Z-12AAH	Cool White	Chrome	Square
E1150Z-13AAH	Cool White	Chrome	Oval
E1150Z-11CAB	Warm White	Chrome	Round
E1150Z-12CAB	Warm White	Chrome	Square
E1150Z-13CAB	Warm White	Chrome	Oval
E1150Z-11E	Blue	Chrome	Round
E1150Z-12E	Blue	Chrome	Square
E1150Z-13E	Blue	Chrome	Oval

Product in Blister Pack includes quantity (1) 530-00486 Closed Cell Foam Gasket in each package.

PHOTOMETRICS

EMBER E1150Z-11CAB

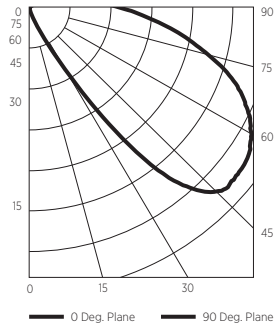

Multiplier Table	3000°K	6500°K
Ember		x1.20

All results are according to IESNA LM-79-2008: Approved Method for the Electrical and Photometric Testing of Solid-State Lighting.

DIMENSIONS

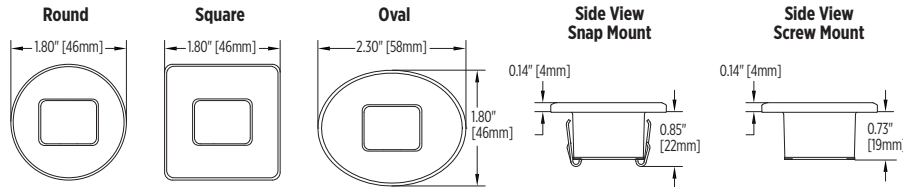

Custom Trim Bezels & Finishes available. Contact us for details.

NOTE: Check bezel alignment prior to removing tape liner. Ramp must contact inside of bezel opening.

MOUNTING

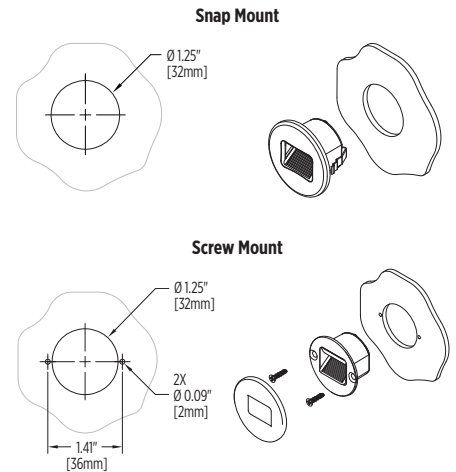

WIRE FUNCTION

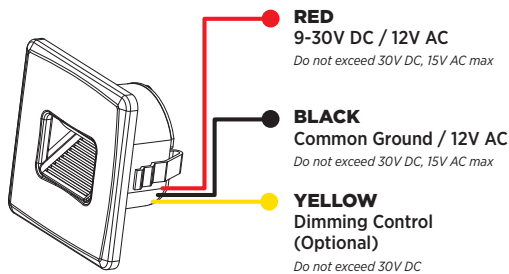

LIGHTLINK™ See wiring examples below.

Using 3rd Party Multiplex & PWM Dimmers:

The Yellow Dimming Control wire is engineered to work with i2Systems LightLink™ Dimmers and 3rd party PWM type dimmers. Do not exceed 30V DC.

To use a 3rd party PWM dimmer, drive the Yellow Dimming Control Wire using a Pulse Width Modulation (PWM) Controller. By driving the Yellow Dimming Control Wire Low to DC Common, the Fixture turns off. By driving the Yellow Dimming Control Wire High to DC Positive (i.e. +24V), or by allowing the wire to Float (no connection), the Fixture turns on to 100%.

The PWM signal must be a Square Wave at a fixed frequency and a maximum voltage of 30V DC. Frequency range may be between 100Hz and 300Hz (user selected). A wiring example is shown on the last page of this spec sheet.

PROTECTION FEATURES



Electrical Protection

- Dim Line Protected to 30V DC
- Transient Protection
- Reverse Polarity Protection
- Auto-Reset Fuse

WIRING EXAMPLE

12/24V DC NO DIMMING

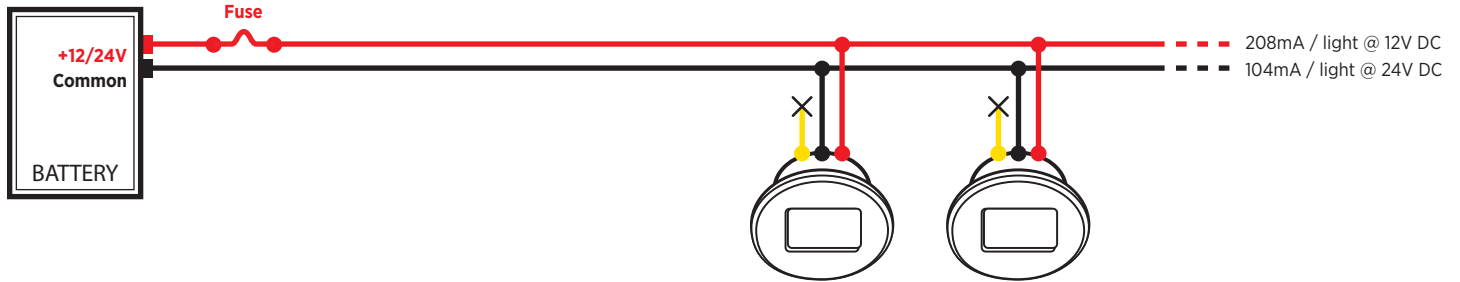

WIRING EXAMPLE

12/24V DC PUSH BUTTON SWITCH DIMMING

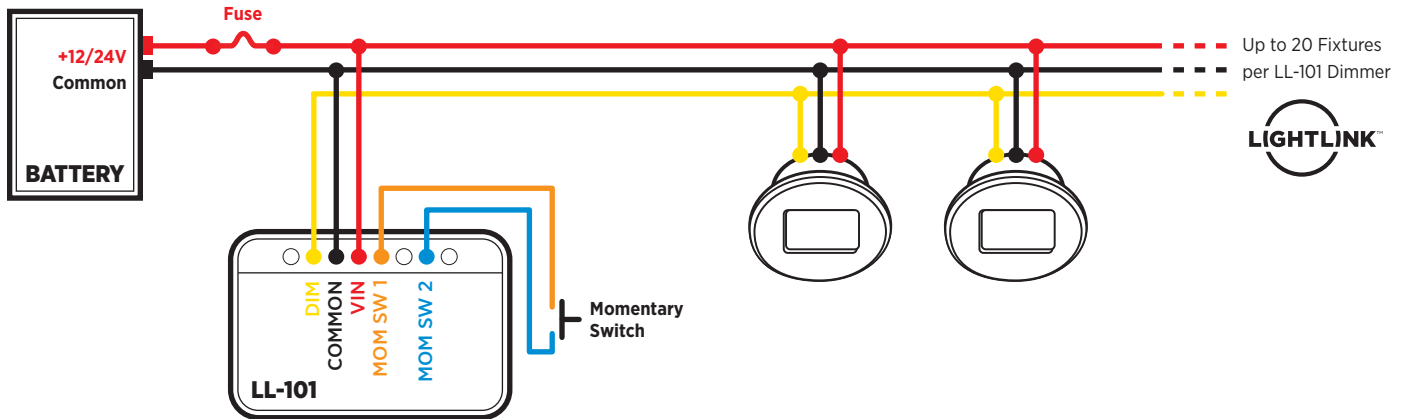

WIRING EXAMPLE

12/24V DC 3RD PARTY MULTIPLEX DIMMER*

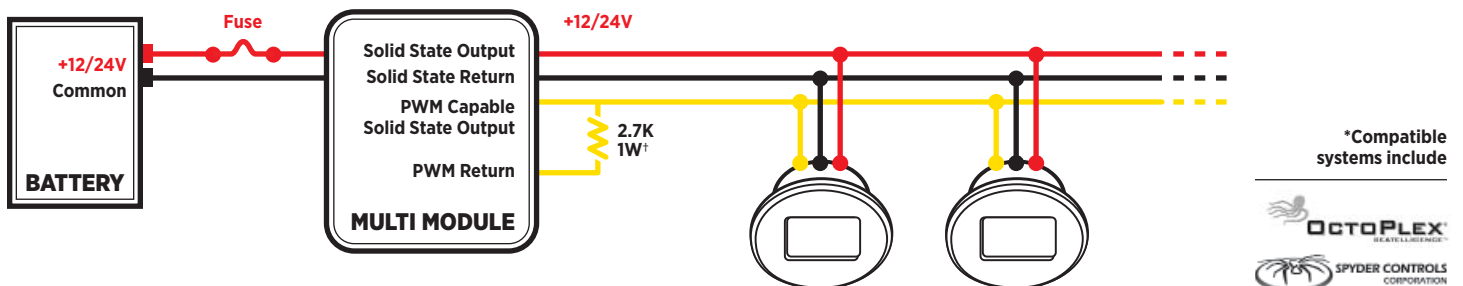

* By driving the Yellow wire Low (i.e. DC Common), the Fixture turns off. Many Multiplex type systems were originally designed for halogen lamps and do not Drive Low, in which case in this example a 2.7K, 1 Watt Pull Down Resistor pulls down the Yellow Dimming Line to DC Common when the PWM is not driven High (thus shutting off the Fixtures).