

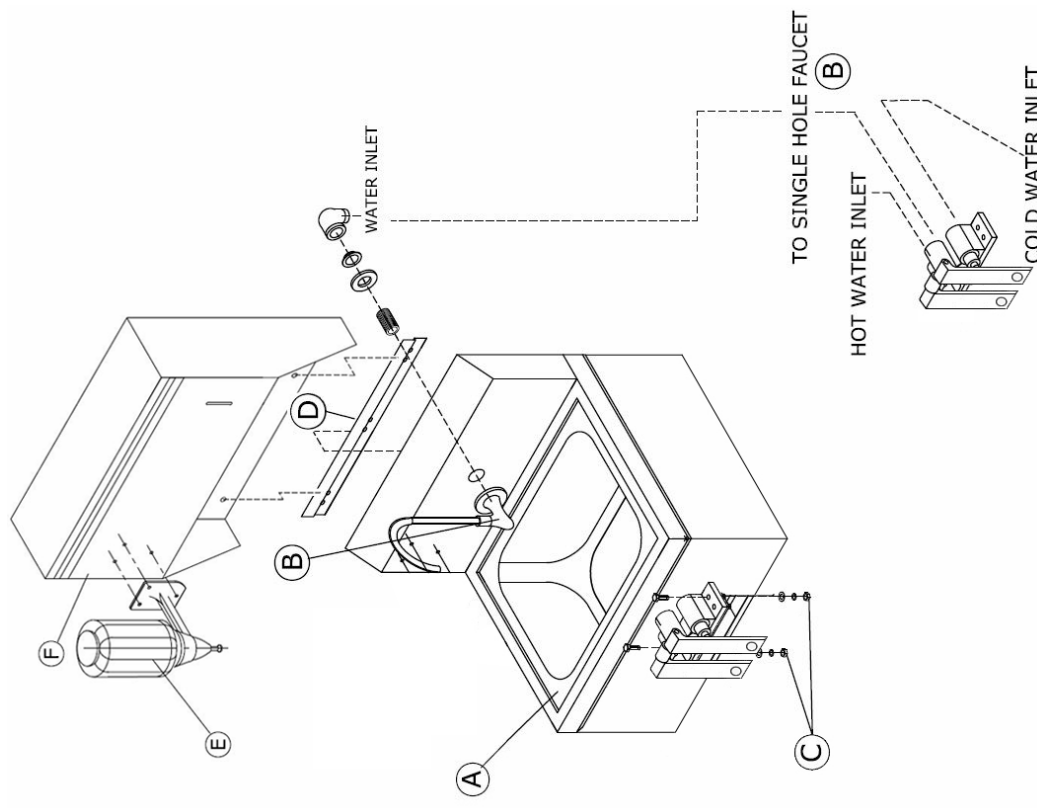

INSTALLATION INSTRUCTIONS for HS-16 16" WIDE SOAP & TOWEL HAND SINK with KNEE VALVE FAUCET

INCLUDES:

- (A) HAND SINK
- (B) SINGLE HOLE FAUCET
- (C) KNEE VALVE
- (D) WALL MOUNT BRACKET
- (E) SOAP DISPENSER
- (F) TOWEL & SOAP DISPENSER



1. Install WALL BRACKET (D) 41⁻³/₈" off finished floor using appropriate hardware (not included)
2. Install KNEE VALVE (C) to front of HAND SINK (A) with appropriate hardware (not included)
3. Install SINGLE HOLE FAUCET (B) on HAND SINK (A) and run water line from center of KNEE VALVE (C) to SINGLE HOLE FAUCET (B).
4. Prepare water line feeds to hook up to KNEE VALVE (C).
5. Install TOWEL & SOAP DISPENSER (F) on wall with the top of the unit 55" off the finished floor and making sure it is level. Open the towel dispenser door and mark the 3 key slots on the top as well as the 2 bottom holes. Using appropriate mounting hardware (not included) install 3 screws at the top of the key slots and install only the mounting hardware for the bottom 2 holes (screws will be installed later). Hang HAND SINK (A) on wall and install WALL BRACKET (D) with opening facing up by inserting screws through TOWEL DISPENSER (F) and into mounting hardware that was previously installed.
6. Install SOAP DISPENSER (E) on front of TOWEL & SOAP DISPENSER (F).
7. Hang HAND SINK (A) on WALL BRACKET (D).
8. Install Drain with plumbers putty on top and the rubber washer & locknut below. Make sure top of drain is below surface to allow proper drainage.
9. Hook up water and drain lines to complete the installation.